

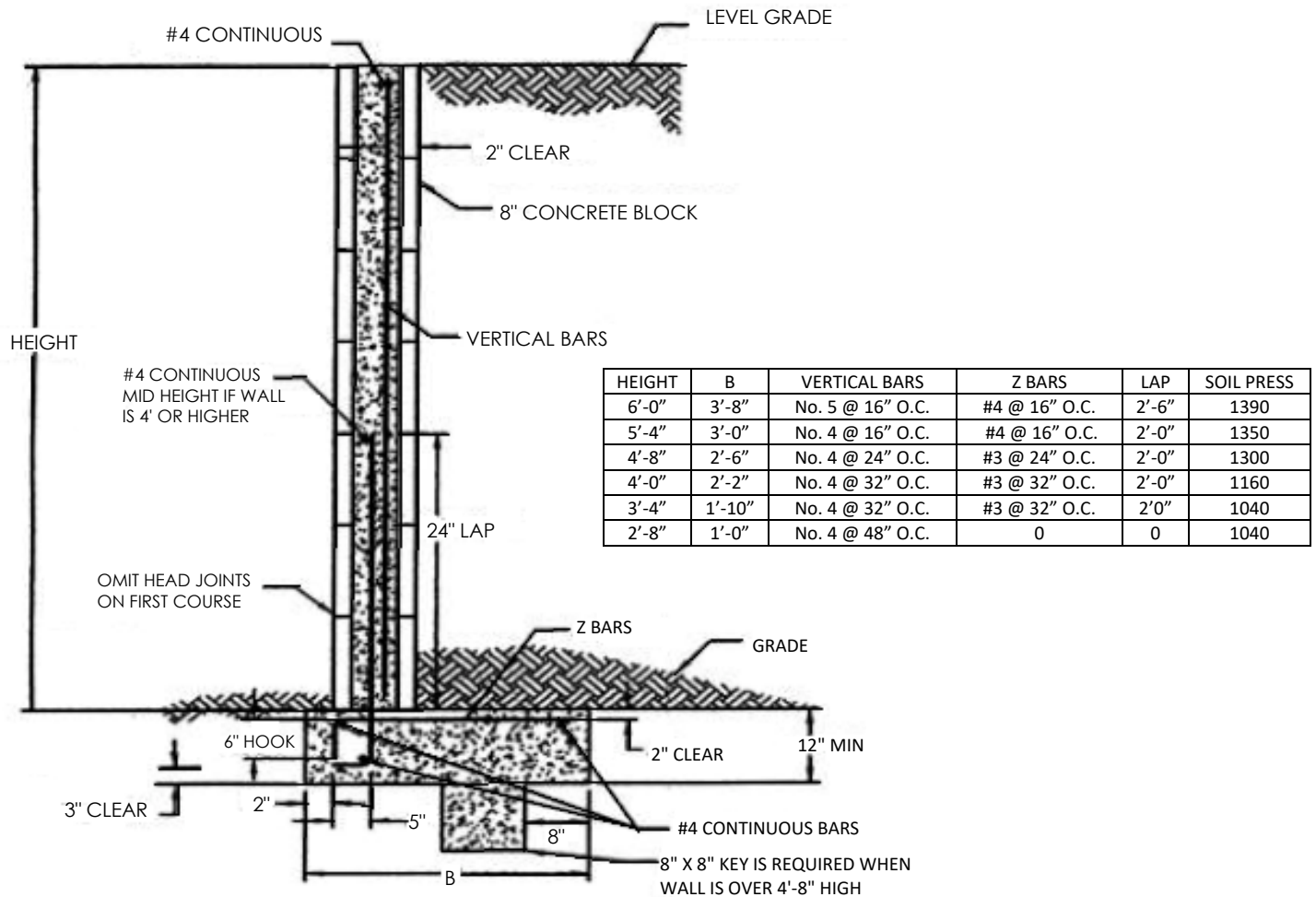

COMMUNITY DEVELOPMENT DEPARTMENT  
 220 E MOUNTIAN VIEW ST. STE A  
 BARSTOW, CA 92311  
 760-255-5161

## RETAINING WALL (CANTILEVER WITH FOOTING UNDER FILL)



**NOTES:**

1. THE MAXIMUM ALLOWABLE HEIGHT IS 6'-0".
2. ALL CELLS ARE TO BE GROUTED SOLID. GROUT TO VIBRATED AND CONSOLIDATED.
3. BLOCK ARE TO BE LAY SO AS TO PROVIDE VERTICAL ALIGNMENT OF ALL CELLS. LAY BLOCK IN 1/2 BOND.
4. FOOTINGS TO BE DUG 12" MINIMUM INTO UNDISTURBED SOIL.
5. FOOTINGS WHERE THE SURFACE OF THE GROUND SLOPES MORE THAN 1 FOOT IN 10 FEET SHALL BE LEVEL OR SHALL BE STEPPED SO THAT BOTH TOP AND BOTTOM OF SUCH FOOTINGS ARE LEVEL.
6. REQUEST INSPECTION FOR STEEL IN WALL AND OBTAIN APPROVAL PRIOR TO POURING.
7. REQUEST INSPECTION FOR STEEL IN WALL AND OBTAIN APPROVAL PRIOR TO GROUTING.
8. WALL IS NOT DESIGNED FOR SURCHARGE LOADS. KEEP ANY AND ALL LOADS EXCEPT LEVEL GRADE, A DISTANCE AT LEAST EQUAL TO THE HEIGHT OF THE WALL, AWAY FROM THE WALL.
9. OBTAIN FINAL INSPECTION AND APPROVAL.

\*MUST PROVIDE PLOT PLAN WITH SPEC



COMMUNITY DEVELOPMENT DEPARTMENT  
 220 E MOUNTIAN VIEW ST. STE A  
 BARSTOW, CA 92311  
 760-255-5161

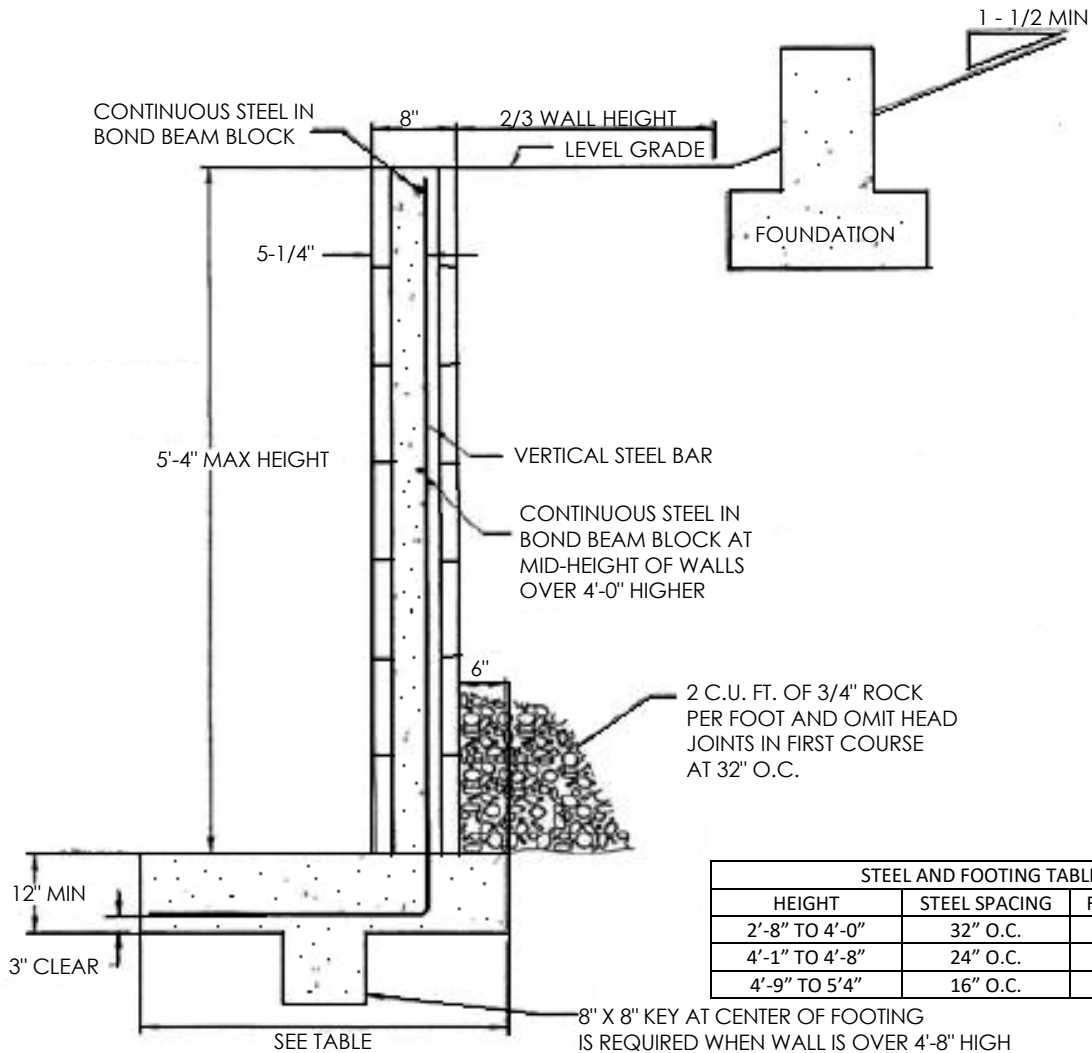

STEEL AND FOOTING TABLE		
HEIGHT	STEEL SPACING	FOOTING WIDTH
2'-8" TO 4'-0"	32" O.C.	2'-2"
4'-1" TO 4'-8"	24" O.C.	2'-6"
4'-9" TO 5'-4"	16" O.C.	3'-0"

**NOTES:**

1. ALL SURCHARGE LOADS ON THE FILL SIDE SHALL BE KEPT BACK FROM THE WALL A DISTANCE EQUAL TO TWO-THIRDS THE HEIGHT OF THE WALL.
2. BACKFILL MAY BE PLACED AFTER THE WALL HAS CURED FOR 14 DAYS.
3. ALL REINFORCING BARS ARE 1/2 INCH DEFORMED STEEL BARS.
4. EVERY OTHER VERTICAL REINFORCING BAR MAY BE STOPPED AT MID-HEIGHT.

**ALTERNATIVE WALL:**

1. USE 8 INCH THICK POURED CONCRETE WITH 1/2 INCH REINFORCING BARS SPACED 15" O.C.
2. BOTH WAYS. LOCATE STEEL 3 INCHES FROM THE FILL SIDE OF THE WALL. FOOTINGS PER TABLE.

\*MUST PROVIDE PLOT PLAN WITH SPEC